

**GENERAL NOTES**

- CHAIN STATION SIGNS SHALL HAVE A WHITE LEGEND AND BORDER ON A BLUE BACKGROUND. ALTERNATE LEGEND "CHAIN-UP STATION" OR "CHAIN-DOWN STATION" MAY BE USED IN PLACE OF THE STANDARD "CHAIN STATION" AS DIRECTED BY THE ENGINEER.
- CHAIN STATION GORE SIGN WITH AN EXIT DIRECTIONAL ARROW (D5-16\_CD) SHALL BE USED WHEN LEAVING THRU LANE LINES. A TEMPORARY TRUCKS ONLY PLAQUE (D5-16P\_CD) MAY SUPPLEMENT THE EXIT GORE SIGN TO DETER PASSENGER VEHICLES FROM ENTERING THE CHAIN STATION. D5-16P\_CD SHOULD BE REMOVED AFTER 2 YEARS OF USE TO REDUCE SIGN CLUTTER.
- UNLAWFUL TO PROCEED WITHOUT REQUIRED EQUIPMENT SIGNS (R13-51\_CD) SHALL BE INSTALLED AT THE DOWNSTREAM END OF THE LAST STATION AVAILABLE FOR CHAIN-UP APPLICATIONS ONLY. NEXT CHAIN STATION SIGNAGE (D5-17\_CD) SHALL NOT BE INSTALLED WITH UNLAWFUL TO PROCEED SIGNAGE.
- CHAIN LAW IN EFFECT SIGNS (R13-50\_CD) AND UNLAWFUL TO PROCEED WITHOUT REQUIRED EQUIPMENT SIGNS (R13-51\_CD) SHALL NOT BE INSTALLED FOR CHAIN DOWN STATION APPLICATIONS.
- CHAIN LAW IN EFFECT SIGNS (R13-50\_CD) SHOULD BE INSTALLED AT APPROACH ROAD INTERSECTIONS OR OTHER LOCATIONS WHERE COMMERCIAL VEHICLES CAN DETOUR OR TURN AROUND SAFELY. A "X MILES AHEAD" PLAQUE (D5-15bP\_CD) SHOULD SUPPLEMENT R13-50\_CD IF IT IS THE FIRST ADVANCE SIGN IN SEQUENCE TO THE CHAIN STATION.
- NEXT CHAIN STATION SIGNAGE (D5-17\_CD) SHOULD BE INSTALLED AT THE END OF SUCCEEDING CHAIN STATIONS.
- VARIABLE MESSAGE SIGNS (VMS) MAY BE USED IN ADDITION OR IN PLACE OF THE CHAIN STATION 2 MILES SIGN (D5-15\_CD) AS DIRECTED BY THE ENGINEER. A ROADWAY CONDITION MESSAGE SHOULD BE DISPLAYED TO INCREASE DRIVER COMPLIANCE WHEN SPEEDS ARE REDUCED AHEAD.  
REFER TO CDOT VMS STATEWIDE GUIDELINES.
- REGULATORY SIGNS, CHAIN LAW IN EFFECT WHEN FLASHING (R13-50\_CD) AND THE UNLAWFUL TO PROCEED WITHOUT REQUIRED EQUIPMENT (R13-51\_CD), MAY BE POSTED ON EACH SIDE OF ROADWAY (DOUBLE POSTED).  
UNLAWFUL TO PROCEED WITHOUT REQUIRED EQUIPMENT SIGN (R13-51\_CD) MAY BE INSTALLED WITH FLASHING BEACONS TO ENHANCE CONSPICUITY.
- NO PARKING 30 MINUTE CHAIN-UP SIGNS (R7-50\_CD) MAY BE HINGED AND FOLDED DURING SUMMER MONTHS IF MORE THAN 1600 FT FROM RESIDENTIAL AREAS AS DIRECTED BY THE REGION TRAFFIC ENGINEER.
- REFER TO S-613-2 FOR CHAIN STATION LIGHTING DETAIL.
- THE USE OF AND FINAL PLACEMENT OF VARIABLE SPEED LIMIT SIGNS SHALL BE APPROVED BY THE REGION TRAFFIC ENGINEER.

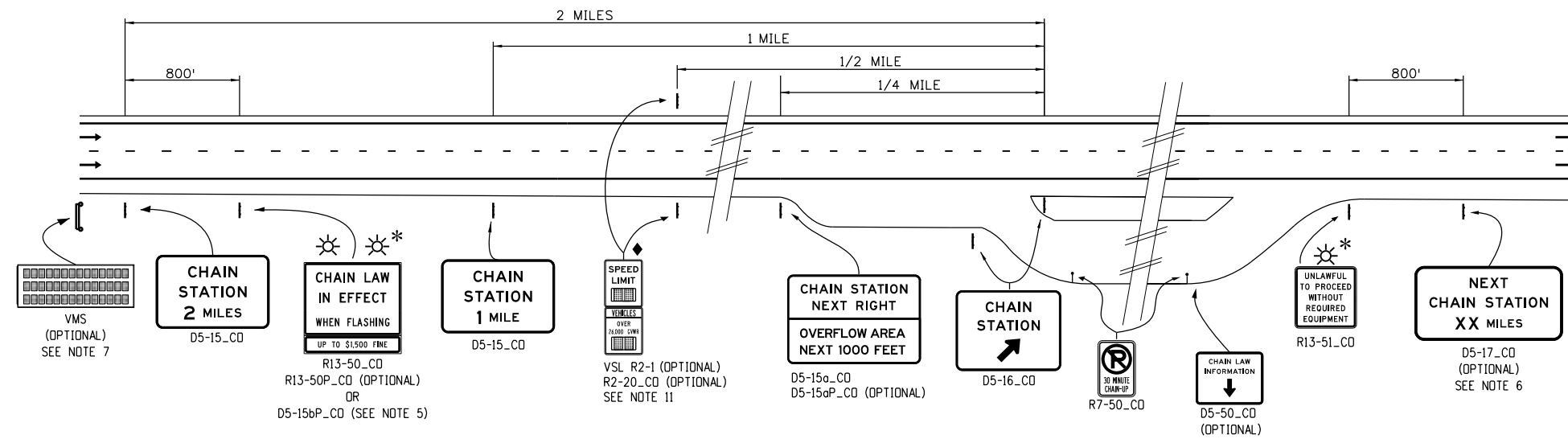

**TYPICAL APPLICATION  
CHAIN STATION - FREEWAY/EXPRESSWAY**

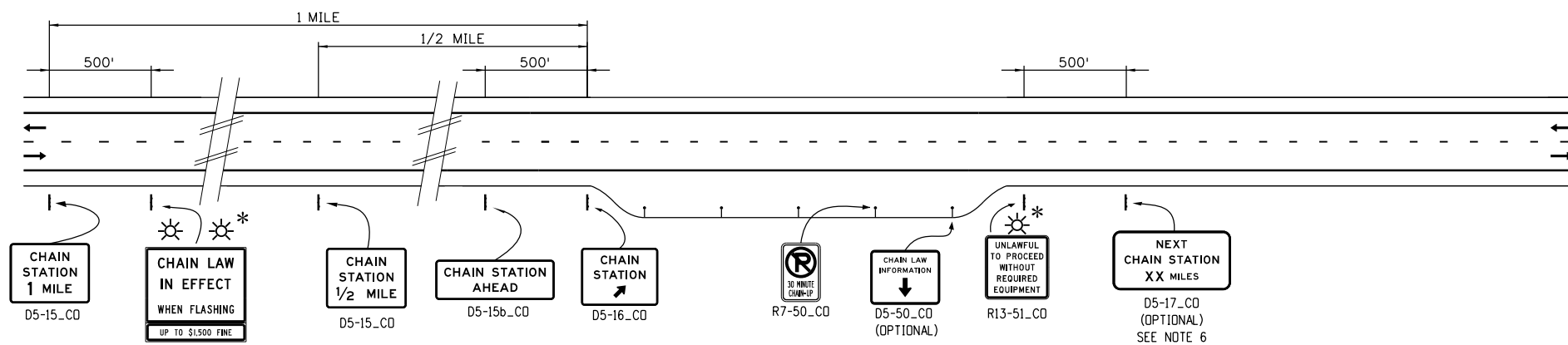

**TYPICAL APPLICATION  
CHAIN STATION - CONVENTIONAL HIGHWAY**

**LEGEND**

- DIRECTION OF TRAVEL
- ☀ FLASHING BEACON
- ↑ OVERHEAD LIGHTING (SEE NOTE 10)
- VMS OPTION (SEE NOTE 7)
- \* DOUBLE POSTED OPTION (SEE NOTE 8)
- ◆ VARIABLE SPEED LIMIT OPTION (SEE NOTE 11)

<b>Computer File Information</b>		<b>Sheet Revisions</b>		<p>Colorado Department of Transportation</p> <p>2829 W. Howard Pl. Denver, CO 80204 Phone: 303-512-9654 FAX: 303-757-9219</p> <p>Traffic Safety &amp; Engineering EB</p>	<h1>CHAIN STATION SIGNAGE</h1>	<b>STANDARD PLAN NO.</b>	
Creation Date: 04/30/24		Date:	Comments:			S-614-15	
Created By: NRIVERA						Standard Sheet No. 1 of 1	
Last Modification Date:						Project Sheet Number:	
Last Modified By:							
CAD Ver.: MicroStation V8 Scale: Not to Scale Units: English				Issued By: Traffic Safety & Engineering Branch April 30, 2024			